

EXISS EXPRESS BP SS EDITION

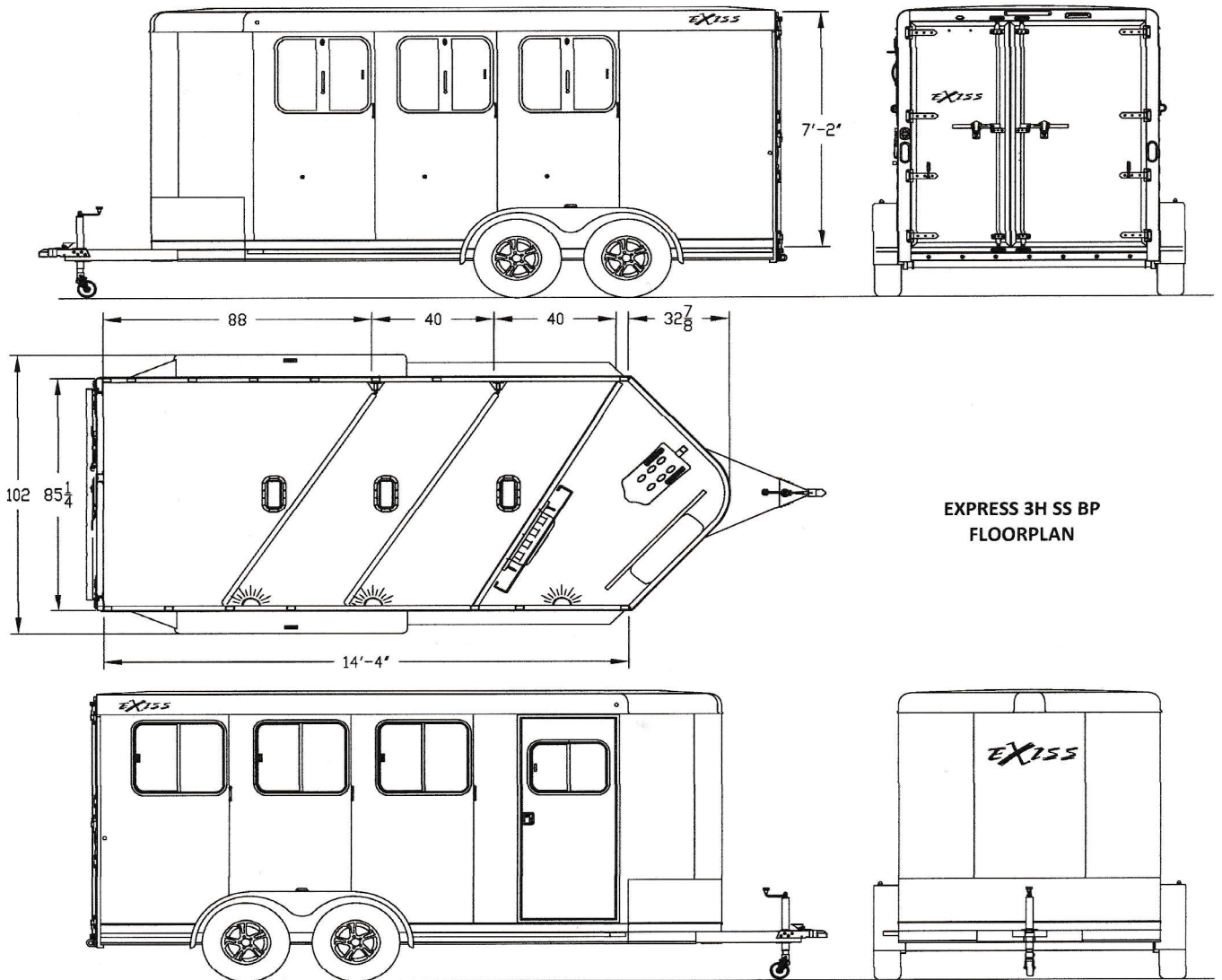

EXPRESS 3H SS BP
FLOORPLAN

MODEL	SIZE	STALLS	GVWR	EMPTY WEIGHT	AXLES	MSRP
3H EXPRESS SS	7'0" X 14'4"	3H	7,000	3,200	(2) 3,500	\$ 33,043.00

EXISS EXPRESS BP SS EDITION TRAILER FEATURES

CONSTRUCTION FEATURES

- 7'2" inside height – 7'0" outside width
- All aluminum construction w/ single piece aluminum roof
- Extruded plank flooring w/ 2" x 4" I-beams on 16" centers
- (2) 3,500 lbs. rubber torsion axles w/ electric brakes
- Aluminum V-hitch w/ 2 5/16" adjustable coupler
- Breakaway switch w/ battery and slip hook safety chains
- Five 15" 6 hole aluminum wheels w/ 8 ply import tires
- Spare tire w/ interior mount
- 2,000 lbs. top-wind jack w/ wheel
- Treadplate gravel guard 16" high on nose
- .040 white aluminum side sheets
- Full length running boards w/ tear-drop fenders
- Full-width rear rubber bumper
- LED brake and running lights
- LED load light at rear of trailer
- Solid wall separating dressing room from horse area
- Two outside tie rings per horse
- 3/8 transferable warranty

HORSE AREA FEATURES

- Horse area walls insulated 48" high
- Rubber installed 48" high on horse area walls
- Aluminum kickplate behind rubber lining
- Two inside tie rings per horse
- Lifetime rubber floor mat in horse area
- Streetside 27" x 31" drop feed windows w/ drop down bars
- Curbside 27" x 31" windows w/ bars and screen
- Slant stall dividers w/ body, shoulder and head separator
- Fully recessed (patented) slam latch for divider
- One pop-up two-way aluminum roof vent per stall
- Double rear doors w/ cam locks and locking hasps
- One interior LED light per divider in horse area
- Full-width nylon strap at rear of trailer

DRESSING ROOM FEATURES

- 0' shortwall dressing room w/ carpeted floor
- One interior LED light in dressing room
- Camper door w/ sliding window
- Adjustable saddle rack on removable post (one per horse)
- Blanket bar, brush tray, clothes rod and six halter hooks